



FEDERAL ENERGY REGULATORY COMMISSION FIELD INSPECTION REPORT

Date June 26, 2024

Project WBI Energy Transmission, Inc.
Wahpeton Expansion Project
Cass and Richland Counties, North Dakota
Docket No.: CP22-466-000
Authority: Section 7(c)

Personnel FERC Project Manager: David Hanobic
FERC Contractor: Tetra Tech, Inc.
FERC Contractor Staff: Krista Dearing
Company Staff: Andrew Bates (Regulatory Affairs Manager);
Jill Linn (Director of Environmental);
Steve Kelly (Project Manager); Rick Pateas
(Lead Environmental Inspector)

Inspection Summary	
<u>0</u>	Problem Areas
<u>0</u>	Noncompliances
<u>N</u>	Follow-Up Letter Required
<u>No</u>	Refer to Enforcement

Introduction

On June 26, 2024, Krista Dearing of Tetra Tech performed a construction inspection of the WBI Energy Transmission, Inc. (WBI) Wahpeton Expansion Project (Project), under contract to the Federal Energy Regulatory Commission (FERC or Commission) and per the request of the FERC Project Manager, David Hanobic.

The Project consists of the construction and operation of a total of approximately 60.2 miles of new natural gas pipeline and appurtenant facilities in Cass and Richland Counties, North Dakota. More specifically, the Project includes:

- construction of an approximately 60.2-mile-long, 12-inch-diameter pipeline extending in a southeastward direction from WBI's existing Mapleton Compressor Station (CS) in Cass County, North Dakota, to the Project's ultimate terminus at the new Wahpeton Border Station in Richland County, North Dakota;
- minor modifications to WBI's existing Mapleton CS;
- construction of the new Montana-Dakota Utilities (MDU)-Wahpeton Border Station;

- construction of the new MDU-Kindred Border Station;
- construction of seven new block valve settings;
- construction of four new pig¹ launcher/receiver stations; and
- construction of new ancillary facilities.

The Project is designed to provide up to approximately 20.6 million cubic feet of natural gas per day to southeastern North Dakota and provide natural gas service for the first time to Kindred, North Dakota. The Project will also include the installation of two farm taps along the pipeline route.

The anticipated in-service timing for the Project is mid-November 2024.

The purpose of the inspection was to determine WBI's compliance with the environmental conditions of the Commission's October 23, 2023 *Order Issuing Certificate* for the Project and to inspect the construction conditions of the pipeline rights-of-way (ROW) and facilities.

The findings of the inspection were that no instances of noncompliance or problem areas were identified.

A site map and photographic record are presented in this report.

Inspection

On June 26, 2024, weather conditions were cloudy, with temperatures ranging from 65°F to 70°F in nearby Fargo, North Dakota. The Project area received a total of approximately 3.0 inches of precipitation during the three weeks preceding the inspection, including approximately 0.3 inch of rain five days before the inspection, according to data collected at the Fargo Hector International Airport. Soil conditions were moist to wet.

The inspection began at the existing WBI Mapleton CS (mile post [MP] 0.0; Photo Numbers [Nos.] 1 and 2), continued south along the ROW, and ended at the Wahpeton Border Station site (MP 59.0) and Wahpeton Storage Yard (Photo Nos. 19 and 20, respectively).

At the WBI Mapleton CS, expansion loop tie-in was in progress, and equipment mats and ECDs were in place within the clearly staked ROW boundaries (Photo Nos. 1 and 2). Along the ROW at MP 1.5 and the Bore #1 site, topsoil was being properly segregated and stockpiled along the edge of the ROW (Photo No. 3), and pipeline was strung or lowered into the trench (Photo Nos. 3, 5, and 7). Project signage was posted, and an equipment mat access pad was in place from the public road (Photo Nos. 4 and 7). WBI stated that one of two self-reported noncompliances was issued at this location for moving the access road from the public road to the ROW to improve safety conditions and access for construction equipment (Photo No. 6). Signage was in place to stop access via the un-approved road, and no other environmental concerns were identified. WBI stated that a recent release of fuel from a fuel truck was restricted to the pavement on the road and a small section of equipment mat (Photo No. 7). The fuel was absorbed with absorbent material which, along with the impacted equipment mat section, was properly disposed of by a licensed contractor. Otherwise along this section of ROW, equipment mats and ECDs were in place within the clearly staked ROW boundaries, and no erosion, off-ROW impacts, or environmental concerns were identified.

WBI stated that a another self-reported noncompliance was issued near MP 5.5 and the Bore #8 site for an error in surveying and grading, placing the ROW in a non-approved location (Photo No. 8). Near MP 6.4 and the Bore #10 site, welding of pipe string was in progress (Photo No. 9). Near MP 7.2 and the

¹ A "pig" is a tool that moves through the pipeline and is used for cleaning, internal inspections, or other purposes. A launcher/receiver is an aboveground structure used to install/retrieve pigs from the pipeline.

Bore #13 site, the graded ROW was stable and clearly staked, with equipment mats and ECDs properly installed, as needed (Photo No. 11). Pipeline stringing was complete up to near MP 11.7 (Photo No. 12); spotters were placed with each grader to prevent topsoil placement beyond the staked ROW near MP 14.8 and the Bore #22 site (Photo No. 13); and grading of the ROW was complete, with equipment mats being installed, as needed, up to near MP 14.9 and the Bore #23 site (Photo No. 14). Along these sections, the ROW was stable, with no off-ROW impacts or environmental concerns identified.

Near MP 16.8 and the Bore #25 site, the agricultural ROW near the Red River Valley and Western Railroad crossing was documented (Photo No. 15). One of two private, one-inch taps will be installed as part of the Project at MP 17.9, near the Bore #26 site (Photo No. 16). Stakes and flagging were in place to delineate the boundaries of the Valve Set 3, near MP 23.5 and the Bore #31 site (Photo No. 17). Near MP 24.4 and the Bore #32 site, a pre-construction view of the Sheyenne River crossing site was documented (Photo No. 18). Grading was not yet underway along these portions of the ROW; however, some initial clearing was conducted as part of staking (Photo Nos. 16 and 17).

At MP 59.0, clearing was complete at the Wahpeton Border Station site; however, no other construction activities had taken place at the time of the inspection (Photo No. 19). The inspection ended at the Wahpeton Storage Yard, where equipment and materials were being mobilized and staged, and no off-ROW impacts or environmental concerns were identified (Photo No. 20).

Conclusions and Recommendations

A follow-up letter is not required at this time, because no instances of noncompliance were identified. Overall, construction was proceeding satisfactorily, environmental conditions were acceptable, and no environmental concerns were identified. The next inspection is scheduled for the week of July 22, 2024.

Site Map

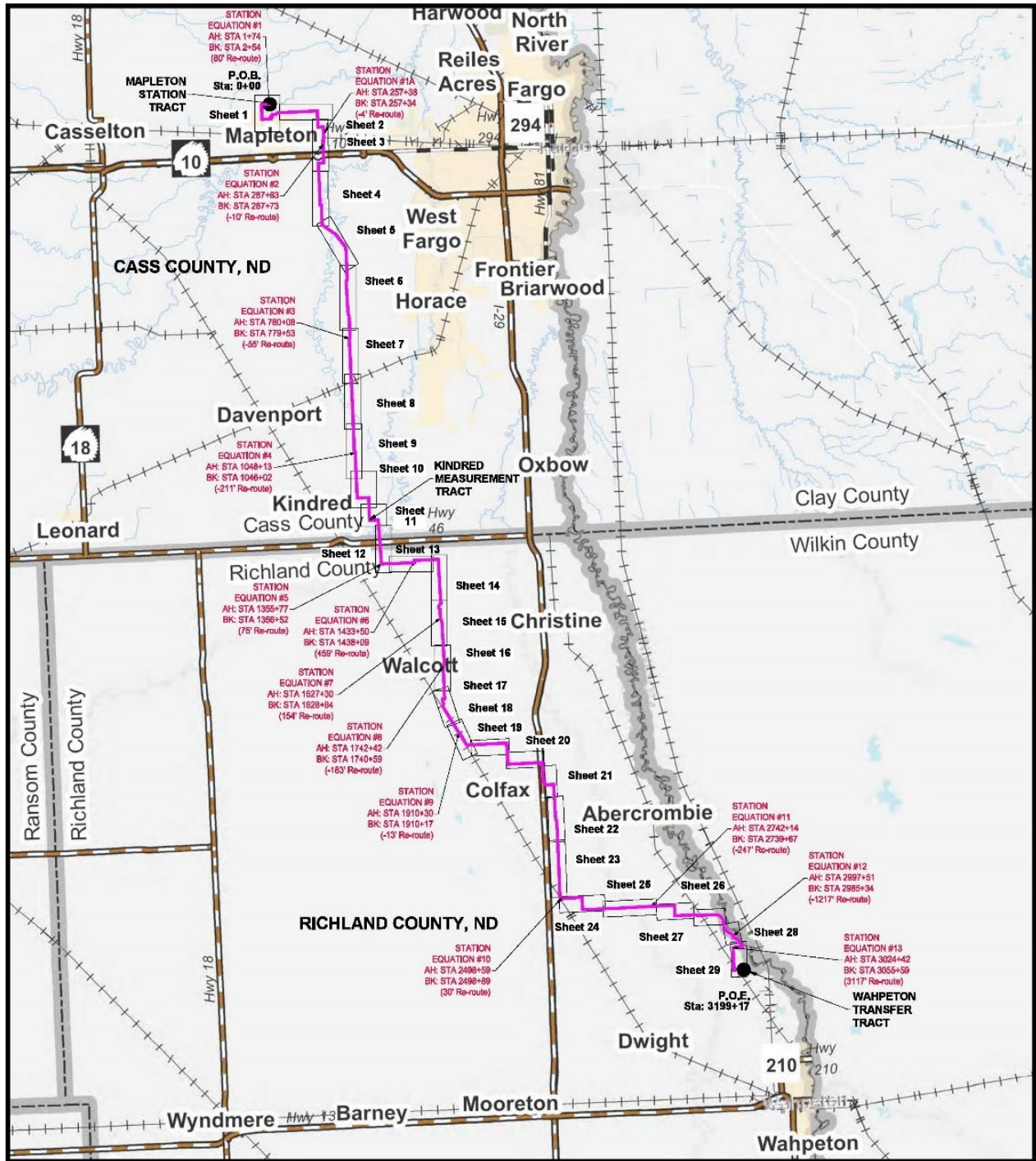

**FEDERAL ENERGY REGULATORY COMMISSION
PHOTOGRAPHIC RECORD**

Company: WBI Energy

Docket Nos.: CP22-466-000

Project: Wahpeton Expansion Project



Photo No.: 1

MP: 0.0

Direction: West

Assessment: Acceptable

Comments: Aboveground Facility, WBI Mapleton CS. At the WBI Mapleton CS, expansion loop tie-in was in progress. Equipment mats and ECDs were in place, and the ROW boundaries were clearly staked. No environmental concerns were identified.



Photo No.: 2

MP: 0.0

Direction: West

Assessment: Acceptable

Comments: Agricultural ROW, WBI Mapleton CS. At the WBI Mapleton CS, the expansion loop ROW was clearly staked, with equipment mats installed over ditch lines and ECDs properly installed, as needed. No environmental concerns were identified.

**FEDERAL ENERGY REGULATORY COMMISSION
PHOTOGRAPHIC RECORD**

Company: WBI Energy

Docket Nos.: CP22-466-000

Project: Wahpeton Expansion Project



Photo No.: 3

MP: 1.5

Direction: West

Assessment: Acceptable

Comments: Agricultural ROW, Bore #1 Site. Topsoil was being properly segregated and stockpiled along the edge of the ROW, and no other environmental concerns were identified.



Photo No.: 4

MP: 1.5

Direction: Northeast

Assessment: Acceptable

Comments: Agricultural ROW, Bore #1 Site. Project signage was posted, the ROW was clearly staked, and an equipment mat access pad was in place from the public road. No environmental concerns were identified.

**FEDERAL ENERGY REGULATORY COMMISSION
PHOTOGRAPHIC RECORD**

Company: WBI Energy.

Docket Nos.: CP22-466-000

Project: Wahpeton Expansion Project



Photo No.: 5

MP: 1.5

Direction: West

Assessment: Acceptable

Comments: Agricultural ROW. Topsoil was segregated and stockpiled along the ROW, ECDs were properly installed, as needed, and pipe was lowered into the trench. No environmental concerns were identified.



Photo No.: 6

MP: 1.5

Direction: West

Assessment: Acceptable

Comments: Agricultural ROW. A self-reported noncompliance was issued for moving the access road near MP 1.5 from the public road to the ROW to improve safety conditions and access for construction equipment. Signage was in place to stop access. No other environmental concerns were identified.

**FEDERAL ENERGY REGULATORY COMMISSION
PHOTOGRAPHIC RECORD**

Company: WBI Energy

Docket Nos.: CP22-466-000

Project: Wahpeton Expansion Project



Photo No.: 7

MP: 1.5

Direction: Northeast

Assessment: Acceptable

Comments: Agricultural ROW. An equipment mat access pad was in place from the public road to the ROW. ECDs were properly installed along the clearly staked ROW. WBI stated that a recent release of fuel from a fuel truck was restricted to the pavement on the road and a small section of the equipment mat. The fuel was absorbed with absorbent material which, along with the impacted equipment mat section, was properly disposed of by a licensed contractor. No environmental concerns were identified.



Photo No.: 8

MP: 5.5

Direction: North

Assessment: Acceptable

Comments: Agricultural ROW, Bore #8 Site. A self-reported noncompliance was issued for a surveyor error that placed the ROW in a non-approved location. No other environmental concerns were identified.

**FEDERAL ENERGY REGULATORY COMMISSION
PHOTOGRAPHIC RECORD**

Company: WBI Energy

Docket Nos.: CP22-466-000

Project: Wahpeton Expansion Project



Photo No.: 9

MP: 6.4

Direction: North

Assessment: Acceptable

Comments: Agricultural ROW, Bore #10 Site. Welding of pipe string was in progress. ECDs were properly installed, as needed, and topsoil was segregated and stockpiled along the edge of the ROW. No environmental concerns were identified.



Photo No.: 10

MP: 6.6

Direction: South

Assessment: Acceptable

Comments: Agricultural ROW. Topsoil was properly segregated and stockpiled along the edge of the ROW. ECDs were in place to prevent sediment transport into the adjacent low-lying wetland area. No environmental concerns were identified.

**FEDERAL ENERGY REGULATORY COMMISSION
PHOTOGRAPHIC RECORD**

Company: WBI Energy

Docket Nos.: CP22-466-000

Project: Wahpeton Expansion Project



Photo No.: 11

MP: 7.2

Direction: East

Assessment: Acceptable

Comments: Agricultural ROW, Bore #13 Site. The ROW was stable and clearly staked, with equipment mats and ECDs properly installed, as needed. No environmental concerns were identified.



Photo No.: 12

MP: 11.7

Direction: East

Assessment: Acceptable

Comments: Agricultural ROW. This location was the end of pipe stringing along the ROW at the time of the inspection. The ROW was stable and clearly staked, with equipment mats and ECDs properly installed, as needed. No environmental concerns were identified.

**FEDERAL ENERGY REGULATORY COMMISSION
PHOTOGRAPHIC RECORD**

Company: WBI Energy

Docket Nos.: CP22-466-000

Project: Wahpeton Expansion Project



Photo No.: 13

MP: 14.8

Direction: East

Assessment: Acceptable

Comments: Agricultural ROW, Bore #22 Site. Spotters were placed with each grader to prevent topsoil placement beyond the staked ROW. The ROW was stable and clearly staked, and no environmental concerns were identified.



Photo No.: 14

MP: 14.9

Direction: South

Assessment: Acceptable

Comments: Agricultural ROW, Bore #23 Site. Equipment mats were being installed to allow access to the ROW. No environmental concerns were identified.

**FEDERAL ENERGY REGULATORY COMMISSION
PHOTOGRAPHIC RECORD**

Company: WBI Energy

Docket Nos.: CP22-466-000

Project: Wahpeton Expansion Project



Photo No.: 15

MP: 16.8

Direction: South

Assessment: Acceptable

Comments: Agricultural ROW, Bore #25 Site. The ROW near the Red River Valley and Western Railroad crossing was documented. Grading was not yet underway along this portion of the ROW.



Photo No.: 16

MP: 17.9

Direction: South

Assessment: Acceptable

Comments: Agricultural ROW, Bore #26 Site. One of two private, one-inch taps will be installed as part of the Project at this location. Grading was not yet underway along this portion of the ROW.

**FEDERAL ENERGY REGULATORY COMMISSION
PHOTOGRAPHIC RECORD**

Company: WBI Energy

Docket Nos.: CP22-466-000

Project: Wahpeton Expansion Project



Photo No.: 17

MP: 23.5

Direction: South

Assessment: Acceptable

Comments: Aboveground Facility, Valve Set 3 Site. Stakes and flagging were in place to delineate the boundaries of the Valve Set 3 site near the Bore #31 site. To date, no construction had occurred in this location.



Photo No.: 18

MP: 24.4

Direction: East

Assessment: Acceptable

Comments: Waterbody ROW, Bore # 32 Site, Sheyenne River. A pre-construction view of the Sheyenne River crossing site was documented.

**FEDERAL ENERGY REGULATORY COMMISSION
PHOTOGRAPHIC RECORD**

Company: WBI Energy

Docket Nos.: CP22-466-000

Project: Wahpeton Expansion Project



Photo No.: 19

MP: 59.0

Direction: East

Assessment: Acceptable

Comments: Aboveground Facility, Wahpeton Border Station. Clearing was complete at the Wahpeton Border Station site. No other construction activities had taken place at the time of the inspection.



Photo No.: 20

MP: N/A

Direction: East

Assessment: Acceptable

Comments: Wahpeton Storage Yard. Equipment and materials were being mobilized and staged at the storage yard. No off-ROW impacts or environmental concerns were identified.