



FEDERAL ENERGY REGULATORY COMMISSION FIELD INSPECTION REPORT

Date July 24 and 25, 2024

Project WBI Energy Transmission, Inc.
Wahpeton Expansion Project
Cass and Richland Counties, North Dakota
Docket No.: CP22-466-000
Authority: Section 7(c)

Personnel FERC Project Manager: David Hanobic
FERC Contractor: Tetra Tech, Inc.
FERC Contractor Staff: Krista Dearing
Company Staff: Andrew Bates (Regulatory Affairs Manager);
Steve Kelly (Project Manager); Greg
Huncovsky (Environmental Project Manager);
Isaac Flicker (Compliance)

Inspection Summary	
<u>0</u>	Problem Areas
<u>0</u>	Noncompliances
<u>No</u>	Follow-Up Letter Required
<u>No</u>	Refer to Enforcement

Introduction

On July 24 and 25, 2024, Krista Dearing of Tetra Tech performed a construction inspection of the WBI Energy Transmission, Inc. (WBI) Wahpeton Expansion Project (Project), under contract to the Federal Energy Regulatory Commission (FERC or Commission) and per the request of the FERC Project Manager, David Hanobic.

The Project consists of the construction and operation of a total of approximately 60.2 miles of new natural gas pipeline and appurtenant facilities in Cass and Richland Counties, North Dakota. More specifically, the Project includes:

- construction of an approximately 60.2-mile-long, 12-inch-diameter pipeline extending in a southeastward direction from WBI's existing Mapleton Compressor Station (CS) in Cass County, North Dakota, to the Project's ultimate terminus at the new Wahpeton Border Station in Richland County, North Dakota;
- minor modifications to WBI's existing Mapleton CS;
- construction of the new Montana-Dakota Utilities (MDU)-Wahpeton Border Station;

- construction of the new MDU-Kindred Border Station;
- construction of seven new block valve settings;
- construction of four new pig¹ launcher/receiver stations; and
- construction of new ancillary facilities.

The Project is designed to provide up to approximately 20.6 million cubic feet of natural gas per day to southeastern North Dakota and provide natural gas service for the first time to Kindred, North Dakota. The Project will also include the installation of two farm taps along the pipeline route.

The anticipated in-service timing for the Project is mid-November 2024.

The purpose of the inspection was to determine WBI's compliance with the environmental conditions of the Commission's October 23, 2023 *Order Issuing Certificate* for the Project and to inspect the construction conditions of the pipeline rights-of-way (ROW) and facilities.

The findings of the inspection were that no instances of noncompliance or problem areas were identified.

A site map and photographic record are presented in this report.

Inspection

On July 24 and 25, 2024, weather conditions were partly cloudy, with temperatures ranging from the mid-70s (°F) to the low-80s (°F) in nearby Fargo, North Dakota. The Project area received a total of approximately 3.3 inches of precipitation during the three weeks preceding the inspection, including approximately 0.4 inch of rain five days before the inspection, according to data collected at the Fargo Hector International Airport. Soil conditions were moist to wet.

The first day of the inspection (July 24, 2024; Photo Numbers [Nos.] 1 through 19) began at the existing WBI Mapleton CS (milepost [MP] 0.0); continued south along the ROW to the Bore #1 site (MP 0.8), Bore #8 site (MP 5.5), Bore #9 site (MP 5.8), and the Valve Set #3 site (MP 11.3); and observed a sensitive resource area (MP 27.3). The first day's inspection also included several stops along the open ROW and waterbody crossings, ending at a waterbody crossing site at MP 31.2.

The second day of the inspection (July 25, 2024; Photo Nos. 20 through 24) began along the ROW at MP 35.8, where the ROW was restricted and undisturbed to protect several migratory bird nests. The inspection continued south to the future Valve Set #5 site (MP 39.6) and ended at the southernmost extent of ROW grading on the north side of I-29 at the future Bore #50 site (MP 40.5).

At the WBI Mapleton CS, the new Valve Set #1 and pad installations were completed and stable (Photo No. 1), and equipment mats and erosion control devices (ECDs) were in place within the clearly staked ROW boundaries. The ROW from west and south of the Mapleton CS was final-graded up to MP 2.0 (Photo Nos. 2 and 4), and the Bore #1 crossing (MP 0.8) was complete with the drill entrance location staked (Photo No. 3). At the Bore #8 crossing beneath the BNSF Railroad (MP 5.5), an equipment mat bridge was in place across the ditch for access, and signs were in place to restrict heavy equipment access. The ROW was clearly staked, with topsoil properly segregated along the edge of the ROW, and welders were on site to weld the pipe string (Photo Nos. 5 and 6). The bore crossing beneath I-94 was in progress and then completed during the inspection, with pipe pulled through the borehole on July 24, 2024 (Bore #9 and Bore #10 sites; Photo Nos. 7 through 10). All drilling mud was contained, and no environmental concerns were identified. At MP 6.2, the WBI pipeline was installed beneath a NuStar

¹ A "pig" is a tool that moves through the pipeline and is used for cleaning, internal inspections, or other purposes. A launcher/receiver is an aboveground structure used to install/retrieve pigs from the pipeline.

pipeline, and a surveyor was collecting data for the Project engineering (Photo No. 11). At the waterbody crossing near the access road to the planned Valve Set #2 site (MP 11.3), the resource was clearly staked and marked with signs. Equipment mats and ECDs were properly installed, as needed (Photo Nos. 12 and 13). The Valve Set #2 site was graded, with topsoil properly segregated along the edge of the ROW, and no off-ROW impacts or environmental concerns identified (Photo No. 13). At MP 17.7, pipe was welded along the ROW with a slight bend in the line to accommodate a shallow water feature crossing (Photo No. 14). Standing water from a recent rain event was observed along low-lying areas of the ROW (Photo No. 15). ECDs were properly installed to prevent off-ROW sediment transport, and no environmental concerns were identified. The Valve Set #3 (Kindred Border Station) installation was complete, and the valve pad was being installed (Photo No. 16). The first layer of soil was being applied on top of geofabric. A second layer of soil would be added, followed by two layers of gravel topped with concrete. The inspection continued on to a sensitive resource area at MP 27.3 (Photo No. 17). No environmental concerns were identified. Two waterbody (canal) crossings at MP 28.1 and MP 31.2 were found to be stable with equipment mat bridges in place for access to the ROW beyond (Photo Nos. 18 and 19). At the ROW access to the planned Valve Set #4 site, overhead powerlines were clearly marked with signs, and topsoil was properly segregated along the edge of the ROW beyond (Photo No. 19). No environmental concerns were identified.

At MP 35.8, access to a segment of the ROW was restricted to protect several migratory bird nests in nearby trees, marked with yellow flagging (Photos Nos. 20 and 21). Work within this area will be avoided until the birds have fledged. Mowing was occurring further along the ROW at MP 36.1 in preparation for grading (Photo No. 22). The location of the planned Valve Set #5 was clearly staked, and topsoil was properly segregated along the edge of the ROW (Photo 23). The inspection ended along the graded ROW adjacent to the planned Bore #50 site on the west side of I-29 (Photo No. 24). This was the southernmost extent of grading along the ROW at the time of the inspection. No off-ROW impacts or environmental concerns were identified.

Conclusions and Recommendations

A follow-up letter is not required at this time, because no instances of noncompliance were identified. Overall, construction was proceeding satisfactorily, environmental conditions were acceptable, and no environmental concerns were identified. The next inspection is scheduled for the week of August 21 and 22, 2024.

Site Map

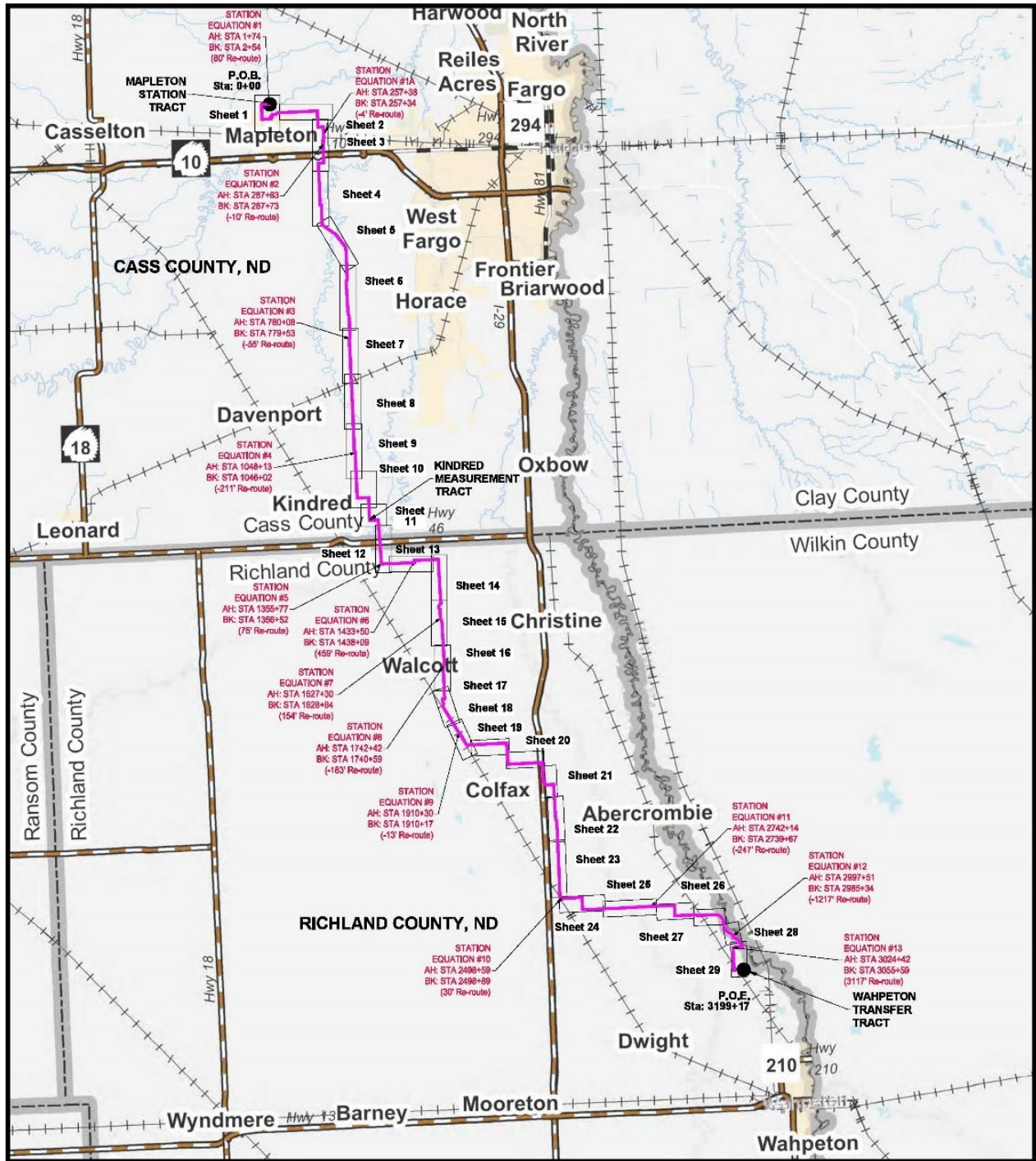

**FEDERAL ENERGY REGULATORY COMMISSION
PHOTOGRAPHIC RECORD**

Company: WBI Energy

Docket Nos.: CP22-466-000

Project: Wahpeton Expansion Project



Photo No.: 1

MP: 0.0

Direction: West

Assessment: Acceptable

Comments: Aboveground Facility, WBI Mapleton CS. At the WBI Mapleton CS, the new Valve Set #1 installation and pad were completed. The site was stable, and no environmental concerns were identified.



Photo No.: 2

MP: 0.2

Direction: West

Assessment: Acceptable

Comments: Agricultural ROW. West of the WBI Mapleton CS, the expansion loop ROW was final-graded, and new vegetation was starting to emerge along the ROW. No environmental concerns were identified.

**FEDERAL ENERGY REGULATORY COMMISSION
PHOTOGRAPHIC RECORD**

Company: WBI Energy

Docket Nos.: CP22-466-000

Project: Wahpeton Expansion Project



Photo No.: 3

MP: 0.8

Direction: South

Assessment: Acceptable

Comments: Agricultural ROW, Bore #1 Site. The drilled crossing was completed, and the entry point was staked. The ROW was final-graded, and no environmental concerns were identified.



Photo No.: 4

MP: 2.0

Direction: East

Assessment: Acceptable

Comments: Agricultural ROW. Final grading was in progress along the ROW, and no environmental concerns were identified.

**FEDERAL ENERGY REGULATORY COMMISSION
PHOTOGRAPHIC RECORD**

Company: WBI Energy.

Docket Nos.: CP22-466-000

Project: Wahpeton Expansion Project



Photo No.: 5

MP: 5.5

Direction: North

Assessment: Acceptable

Comments: Agricultural ROW, Bore #8 Site. At the planned crossing beneath the BNSF Railroad, an equipment mat bridge was in place across the ditch for access; however, signs were in place to restrict heavy equipment access. The ROW was clearly staked, with topsoil properly segregated along the edge of the ROW. The pipe was strung and welders were on site. No environmental concerns were identified.



Photo No.: 6

MP: 5.5

Direction: South

Assessment: Acceptable

Comments: Agricultural ROW, Bore #8 Site. At the planned crossing beneath the BNSF Railroad, an equipment mat bridge was in place across the ditch for access; however, signs were in place to restrict heavy equipment access. The ROW was clearly staked, with topsoil properly segregated along the edge of the ROW. The pipe was staged for welding. No environmental concerns were identified.

**FEDERAL ENERGY REGULATORY COMMISSION
PHOTOGRAPHIC RECORD**

Company: WBI Energy

Docket Nos.: CP22-466-000

Project: Wahpeton Expansion Project



Photo No.: 7

MP: 5.8

Direction: West

Assessment: Acceptable

Comments: Agricultural ROW, Bore #9 Site. On the west side of I-94, the crossing was in progress and then completed during the inspection, with pipe pulled through the borehole on July 24, 2024. All drilling mud was contained, and no environmental concerns were identified.



Photo No.: 8

MP: 5.8

Direction: East

Assessment: Acceptable

Comments: Agricultural ROW, Bore #9 Site. On the west side of I-94, the crossing was in progress and then completed during the inspection, with pipe pulled through the borehole on July 24, 2024. All drilling mud was contained, and no environmental concerns were identified.

**FEDERAL ENERGY REGULATORY COMMISSION
PHOTOGRAPHIC RECORD**

Company: WBI Energy

Docket Nos.: CP22-466-000

Project: Wahpeton Expansion Project



Photo No.: 9

MP: 6.0

Direction: East

Assessment: Acceptable

Comments: Agricultural ROW, Bore #10 Site. On the east side of the I-94 crossing, the pipe string was being lifted for insertion through the borehole. Recent rains resulted in standing water in the trench. A crew was ready to test pipe coating prior to insertion into borehole.



Photo No.: 10

MP: 6.0

Direction: West

Assessment: Acceptable

Comments: Agricultural ROW, Bore #10 Site. On east side of the I-94 crossing, the pipe string was pulled west through the borehole beneath I-94.

**FEDERAL ENERGY REGULATORY COMMISSION
PHOTOGRAPHIC RECORD**

Company: WBI Energy

Docket Nos.: CP22-466-000

Project: Wahpeton Expansion Project



Photo No.: 11

MP: 6.2

Direction: Northeast

Assessment: Acceptable

Comments: Agricultural ROW. The WBI pipeline crosses beneath a NuStar pipeline, and a surveyor was collecting data for the Project engineering. The ROW was stable, with no off-ROW impacts or environmental concerns identified.



Photo No.: 12

MP: 11.3

Direction: East

Assessment: Acceptable

Comments: Agricultural ROW, Waterbody Crossing Site. At the waterbody crossing near the access road to the planned Valve Set #2 site, the resource was clearly staked and marked with signs. Equipment mats and ECDs were properly installed, as needed. No environmental concerns were identified.

**FEDERAL ENERGY REGULATORY COMMISSION
PHOTOGRAPHIC RECORD**

Company: WBI Energy

Docket Nos.: CP22-466-000

Project: Wahpeton Expansion Project



Photo No.: 13

MP: 11.3

Direction: East

Assessment: Acceptable

Comments: Agricultural ROW, Waterbody Crossing, Valve Set #2 Site. At the waterbody crossing near the access road to the planned Valve Set #2 site, the resource was clearly staked and marked with signs. Equipment mats and ECDs were properly installed, as needed. Along the workspace, topsoil was properly segregated along the edge of the ROW, and no off-ROW impacts or environmental concerns were identified.



Photo No.: 14

MP: 17.7

Direction: East

Assessment: Acceptable

Comments: Agricultural ROW. Pipe was welded along the ROW with a slight bend in the line to accommodate a shallow water feature crossing. No environmental concerns were identified.

**FEDERAL ENERGY REGULATORY COMMISSION
PHOTOGRAPHIC RECORD**

Company: WBI Energy

Docket Nos.: CP22-466-000

Project: Wahpeton Expansion Project



Photo No.: 15

MP: 17.9

Direction: East

Assessment: Acceptable

Comments: Agricultural ROW. Standing water from a recent rain event was observed along low-lying areas of the ROW. ECDs were properly installed to prevent off-ROW sediment transport, and no environmental concerns were identified.



Photo No.: 16

MP: 23.2

Direction: Northeast

Assessment: Acceptable

Comments: Aboveground Facility, Valve Set #3 Site (Kindred Border Station). The valve set installation was complete, and the valve pad was being installed. The first layer of soil was being applied on top of geofabric. A second layer of soil would be added, followed by two layers of gravel topped with concrete.

**FEDERAL ENERGY REGULATORY COMMISSION
PHOTOGRAPHIC RECORD**

Company: WBI Energy

Docket Nos.: CP22-466-000

Project: Wahpeton Expansion Project



Photo No.: 17

MP: 27.3

Direction: South

Assessment: Acceptable

Comments: Agricultural ROW. The sensitive resource area was inspected and no environmental concerns were identified.



Photo No.: 18

MP: 28.1

Direction: South

Assessment: Acceptable

Comments: Open ROW, Waterbody Crossing. An equipment mat bridge was installed at the canal crossing to access the ROW beyond. No environmental concerns were identified.

**FEDERAL ENERGY REGULATORY COMMISSION
PHOTOGRAPHIC RECORD**

Company: WBI Energy

Docket Nos.: CP22-466-000

Project: Wahpeton Expansion Project



Photo No.: 19

MP: 31.2

Direction: East

Assessment: Acceptable

Comments: Open ROW, Waterbody Crossing. An equipment mat bridge was in place across the canal for access to the planned Valve Set #4 site. Overhead powerlines were clearly marked with signs, topsoil was properly segregated along the edge of the ROW, and no environmental concerns were identified.



Photo No.: 20

MP: 35.8

Direction: Northeast

Assessment: Acceptable

Comments: Open ROW. Access to the ROW was restricted to protect several migratory bird nests in nearby trees. Work within this area will be avoided until the birds have fledged.

**FEDERAL ENERGY REGULATORY COMMISSION
PHOTOGRAPHIC RECORD**

Company: WBI Energy

Docket Nos.: CP22-466-000

Project: Wahpeton Expansion Project



Photo No.: 21

MP: 35.8

Direction: East

Assessment: Acceptable

Comments: Open ROW. Access to the ROW was restricted to protect several migratory bird nests in nearby trees (marked with yellow flagging). Work within this area will be avoided until the birds have fledged.



Photo No.: 22

MP: 36.1

Direction: Northeast

Assessment: Acceptable

Comments: Open ROW. Mowing was in progress along the ROW in preparation for grading. No environmental concerns were identified.

**FEDERAL ENERGY REGULATORY COMMISSION
PHOTOGRAPHIC RECORD**

Company: WBI Energy

Docket Nos.: CP22-466-000

Project: Wahpeton Expansion Project



Photo No.: 23

MP: 39.6

Direction: North

Assessment: Acceptable

Comments: Agricultural ROW, Valve Set #5 Site. The planned valve set site was clearly staked, with topsoil properly segregated along the edge of the ROW. No off-ROW impacts or environmental concerns were identified.



Photo No.: 24

MP: 40.5

Direction: East

Assessment: Acceptable

Comments: Agricultural ROW, Bore #50 Site. The edge of the Bore #50 site, on the west side of I-29, was the southernmost extent of grading along the ROW at the time of the inspection. No off-ROW impacts or environmental concerns were identified.