



## FEDERAL ENERGY REGULATORY COMMISSION FIELD INSPECTION REPORT

**Date** August 21 and 22, 2024

**Project** WBI Energy Transmission, Inc.  
Wahpeton Expansion Project  
Cass and Richland Counties, North Dakota  
Docket No.: CP22-466-000  
Authority: Section 7(c)

**Personnel** FERC Project Manager: David Hanobic  
FERC Contractor: Tetra Tech, Inc.  
FERC Contractor Staff: Krista Dearing  
Company Staff: Andrew Bates (Regulatory Affairs Manager);  
Steve Kelly (Project Manager); Hutson  
McCann (Environmental Compliance)

Inspection Summary	
<u>0</u>	Problem Areas
<u>0</u>	Noncompliances
<u>No</u>	Follow-Up Letter Required
<u>No</u>	Refer to Enforcement

### Introduction

On August 21 and 22, 2024, Krista Dearing of Tetra Tech performed a construction and restoration inspection of the WBI Energy Transmission, Inc. (WBI) Wahpeton Expansion Project (Project), under contract to the Federal Energy Regulatory Commission (FERC or Commission) and per the request of the FERC Project Manager, David Hanobic.

The Project consists of the construction and operation of a total of approximately 60.2 miles of new natural gas pipeline and appurtenant facilities in Cass and Richland Counties, North Dakota. More specifically, the Project includes:

- construction of an approximately 60.2-mile-long, 12-inch-diameter pipeline extending in a southeastward direction from WBI's existing Mapleton Compressor Station (CS) in Cass County, North Dakota, to the Project's ultimate terminus at the new Wahpeton Border Station in Richland County, North Dakota;
- minor modifications to WBI's existing Mapleton CS;
- construction of the new Montana-Dakota Utilities (MDU)-Wahpeton Border Station;
- construction of the new MDU-Kindred Border Station;

- construction of seven new block valve settings;
- construction of four new pig<sup>1</sup> launcher/receiver stations; and
- construction of new ancillary facilities.

The Project is designed to provide up to approximately 20.6 million cubic feet of natural gas per day to southeastern North Dakota and provide natural gas service for the first time to Kindred, North Dakota.

The anticipated in-service timing for the Project is November 1, 2024.

The purpose of the inspection was to determine WBI's compliance with the environmental conditions of the Commission's October 23, 2023 *Order Issuing Certificate* for the Project and to inspect the construction and restoration conditions of the pipeline rights-of-way (ROW) and facilities.

The findings of the inspection were that no instances of noncompliance or problem areas were identified.

A site map and photographic record are presented in this report.

## **Inspection**

On August 21 and 22, 2024, weather conditions were partly cloudy, with temperatures ranging from the mid-70s (°F) to the low-80s (°F) in nearby Fargo, North Dakota. The Project area received a total of approximately 5.0 inches of precipitation during the week preceding the inspection, including approximately 1.5 inches of rain three days before the inspection, according to data collected at the Fargo Hector International Airport. Soil conditions were saturated to flooded.

The first day of the inspection (August 21, 2024; Photo Numbers [Nos.] 1 through 16) began at the existing WBI Mapleton CS (milepost [MP] 0.0); continued south along the ROW to Valve Set #2 (MP 11.3), the horizontal directional drill (HDD) site at BNSF Railroad (MP 16.8), Valve Set #3 (MP 23.2), Bore #35 (MP 27.6), and Bore # 37 (MP 35.8); and ended at Valve Set #5 (39.5).

The second day of the inspection (August 22, 2024; Photo Nos. 17 through 26) began the new Wahpeton Border station site at the southern terminus of the Project (MP 59); continued north along the ROW to the Wild Rice River HDD site (MP 51.5), Valve Set #6, and the Pitcairn Creek HDD site (MP 44.9); and ended at MP 42, where the ROW parallels the onramp to Interstate 29 (I-29) from County Road 4.

At the WBI Mapleton CS, the new Valve Set #1 and pad installations were complete and stable, and equipment mats had been removed from the ROW access point for final cleanup (Photo No. 1). Bores #7 and #8, located south of the NuStar Facility (approximately MP 5.5), were completed as one crossing. The ROW on the west side of the Bore #8 crossing was heavily flooded from heavy rainfall the week before the inspection (Photo No. 2). Saturated/flooded soils conditions have prevented equipment from accessing the ROW for ongoing construction activities. The ROW was also flooded at the Bore #16 site, where several pieces of heavy equipment remained in place to minimize rutting along the ROW (Photo No. 3). The Valve Set #2 installation was complete, but pad installation was delayed by ROW flooding (Photo No. 4). Erosion control devices (ECDs) protected the adjacent waterbody from sediment migration. The ROW south of the Bore #18 crossing was completely flooded, preventing access; however, segregated topsoil remained stable (Photo No. 5). The Bore # 25 crossing beneath the BNSF Railroad was pending (Photo No. 6). Several lifts of soil were placed on top of geofabric at the Valve Set #3 site (Kindred Border Station); however, completion of the pad was delayed by flooding (Photo No. 7). The pipeline tie-in site at MP. 25.8 was extremely muddy, delaying completion of the tie-in (Photo No. 8). ROW clearing and grading were completed along an area formerly closed to access due

---

<sup>1</sup> A "pig" is a tool that moves through the pipeline and is used for cleaning, internal inspections, or other purposes. A launcher/receiver is an aboveground structure used to install/retrieve pigs from the pipeline.

to a potential sensitive resource area (Photo No. 9). The Bore #35 site for crossing beneath a wetland area was flooded; however, ECDs prevented any sediment migration into the wetland (Photo Nos. 10, 11, and 12). The ROW and Bore #37 site were also flooded; preventing access for construction activities. However, the ROW appeared stable with no off-ROW impacts or environmental concerns identified (Photo No. 13). Along the ROW near/at the Bore #42 crossing, clearing and grading were in progress, where the area was previously closed to protect nesting birds (Photo Nos. 14 and 15). The Valve Set #5 installation was complete; however, completion of the pad was delayed by flooding (Photo No. 16).

At MP 59, the new Wahpeton Border Station site, clearing and grading were observed (Photograph 17). The southern half of the ROW was less inundated with water than the northern half, so a welding crew was welding the pipe on the ROW at MP 55 (Photo No. 18). Welded pipe string was staged along the ROW for the Bore #67 crossing, pending favorable working conditions (Photo No. 19). Access to Bore # 64 site, for crossing beneath the Wild Rice River, was saturated/muddy but protected with equipment mats to allow access for the drill rig. Trenching along the ROW was pending, awaiting dryer soil conditions (Photos Nos. 20 and 21). The Valve Set #6 installation was complete; however, completion of the pad was delayed by heavy rains, which also rendered the ROW inaccessible (Photo No. 22). The ROW at MP 47.4 was flooded, preventing access (Photo No. 23). The Bore # 57 crossing beneath Pitcairn Creek was in progress (Photo Nos. 24 and 25). All drilling mud was contained, and no environmental concerns were identified. The ROW west of the onramp to I-29 from County Road 4 was clearly staked, with topsoil properly segregated (Photo No. 26). All work was within approved workspace limits, with no off-ROW impacts or environmental concerns identified.

### **Conclusions and Recommendations**

A follow-up letter is not required at this time, because no instances of noncompliance were identified. Overall and despite the soil conditions, construction was proceeding satisfactorily, environmental conditions were acceptable, and no environmental concerns were identified. The next inspection is scheduled for the week of September 19 and 20, 2024.

# Site Map

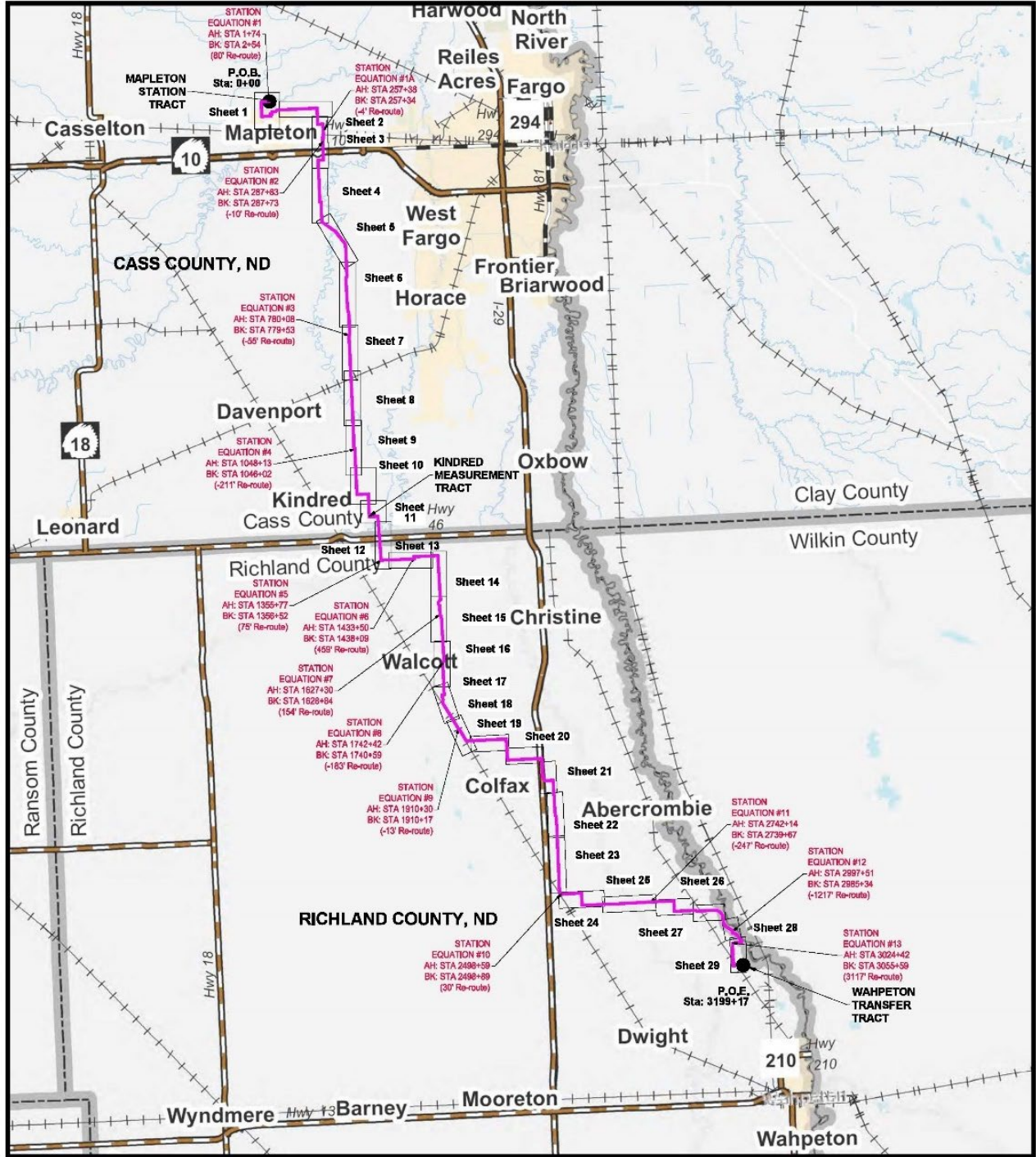

**FEDERAL ENERGY REGULATORY COMMISSION  
PHOTOGRAPHIC RECORD**

**Company:** WBI Energy

**Docket Nos.:** CP22-466-000

**Project:** Wahpeton Expansion Project



**Photo No.:** 1

**MP:** 0.0

**Direction:** South

**Assessment:** Acceptable

**Comments:** Agricultural ROW. At the WBI Mapleton CS, the new Valve Set #1 and pad installations were complete and stable (not pictured), and equipment mats were removed from the ROW access point for final cleanup. No environmental concerns were identified.



**Photo No.:** 2

**MP:** 5.5

**Direction:** South

**Assessment:** Acceptable

**Comments:** Agricultural ROW, Bore #8 Site. The ROW on the west side of the bore crossing was flooded from heavy rainfall the week before the inspection. Saturated/flooded soils conditions prevented equipment from accessing the ROW for ongoing construction activities. No environmental concerns were identified.

**FEDERAL ENERGY REGULATORY COMMISSION  
PHOTOGRAPHIC RECORD**

**Company:** WBI Energy

**Docket Nos.:** CP22-466-000

**Project:** Wahpeton Expansion Project



**Photo No.:** 3

**MP:** 9.2

**Direction:** North

**Assessment:** Acceptable

**Comments:** Agricultural ROW, Bore #16 Site. The ROW was flooded at the bore crossing site, where several pieces of heavy equipment remained in place to minimize rutting along the ROW. No environmental concerns were identified.



**Photo No.:** 4

**MP:** 11.3

**Direction:** East

**Assessment:** Acceptable

**Comments:** Aboveground Facility, Valve Set #2 Site. The valve set installation was complete, but pad installation was delayed by flooding. ECDs protected the adjacent waterbody from sediment migration. No environmental concerns were identified.

**FEDERAL ENERGY REGULATORY COMMISSION  
PHOTOGRAPHIC RECORD**

**Company:** WBI Energy

**Docket Nos.:** CP22-466-000

**Project:** Wahpeton Expansion Project



**Photo No.:** 5

**MP:** 15

**Direction:** South

**Assessment:** Acceptable

**Comments:** Agricultural ROW. The ROW south of the Bore #18 crossing was completely flooded, preventing access. Segregated topsoil was stable, and no environmental concerns were identified.



**Photo No.:** 6

**MP:** 16.8

**Direction:** South

**Assessment:** Acceptable

**Comments:** Agricultural ROW, Bore #25 Site. Pipe segments were staged for welding, but the crossing beneath the BNSF Railroad was pending. The ROW was clearly staked, with topsoil properly segregated along the edge of the ROW. No environmental concerns were identified.

**FEDERAL ENERGY REGULATORY COMMISSION  
PHOTOGRAPHIC RECORD**

**Company:** WBI Energy

**Docket Nos.:** CP22-466-000

**Project:** Wahpeton Expansion Project



**Photo No.:** 7

**MP:** 23.2

**Direction:** Northeast

**Assessment:** Acceptable

**Comments:** Aboveground Facility, Valve Set #3 Site (Kindred Border Station). Several lifts of soil were installed on top of geofabric at the valve set site; however, completion of the pad was delayed by flooding. No environmental concerns were identified.



**Photo No.:** 8

**MP:** 25.8

**Direction:** North

**Assessment:** Acceptable

**Comments:** Agricultural ROW. The pipeline tie-in site was extremely muddy, delaying completion of the tie-in. No environmental concerns were identified.



**FEDERAL ENERGY REGULATORY COMMISSION  
PHOTOGRAPHIC RECORD**

**Company:** WBI Energy

**Docket Nos.:** CP22-466-000

**Project:** Wahpeton Expansion Project



**Photo No.:** 9

**MP:** 27.5

**Direction:** North

**Assessment:** Acceptable

**Comments:** Agricultural ROW. ROW clearing and grading were completed along an area formerly closed to access due to a potential sensitive resource area. No environmental concerns were identified.



**Photo No.:** 10

**MP:** 27.6

**Direction:** West

**Assessment:** Acceptable

**Comments:** Agricultural ROW, Bore #35 Site. The bore site for crossing beneath the wetland area was flooded; however, ECDs had prevented any sediment migration into the wetland. No environmental concerns were identified.

**FEDERAL ENERGY REGULATORY COMMISSION  
PHOTOGRAPHIC RECORD**

**Company:** WBI Energy

**Docket Nos.:** CP22-466-000

**Project:** Wahpeton Expansion Project



**Photo No.:** 11

**MP:** 27.6

**Direction:** East

**Assessment:** Acceptable

**Comments:** Agricultural ROW, Bore #35 Site. The bore crossing sites were flooded on both sides of the road. However, the ROW was stable, with no off-ROW impacts or environmental concerns identified.



**Photo No.:** 12

**MP:** 27.6

**Direction:** West

**Assessment:** Acceptable

**Comments:** Agricultural ROW, Bore #35 Site. The bore crossing sites were flooded on both sides of the road. However, the ROW was stable, with no off-ROW impacts or environmental concerns identified.

**FEDERAL ENERGY REGULATORY COMMISSION  
PHOTOGRAPHIC RECORD**

**Company:** WBI Energy

**Docket Nos.:** CP22-466-000

**Project:** Wahpeton Expansion Project



**Photo No.:** 13

**MP:** 29.4

**Direction:** East

**Assessment:** Acceptable

**Comments:** Agricultural ROW, Bore #37 Site. The bore crossing site and ROW were flooded, preventing access. However, the ROW was stable, with no off-ROW impacts or environmental concerns identified.



**Photo No.:** 14

**MP:** 35.8

**Direction:** South

**Assessment:** Acceptable

**Comments:** Open ROW, Bore #42 Site. Along the ROW near/at the Bore # 42 crossing, clearing and grading were in progress, where the area was previously closed to protect nesting birds. No environmental concerns were identified.

**FEDERAL ENERGY REGULATORY COMMISSION  
PHOTOGRAPHIC RECORD**

**Company:** WBI Energy

**Docket Nos.:** CP22-466-000

**Project:** Wahpeton Expansion Project



**Photo No.:** 15

**MP:** 35.8

**Direction:** North

**Assessment:** Acceptable

**Comments:** Open ROW, Bore #42 Site. Along the ROW near/at the Bore # 42 crossing, clearing and grading were in progress, where the area was previously closed to protect nesting birds. No environmental concerns were identified.



**Photo No.:** 16

**MP:** 39.5

**Direction:** North

**Assessment:** Acceptable

**Comments:** Aboveground Facility, Valve Set #5 Site. The valve set installation was complete; however, completion of the pad was delayed by flooding. No environmental concerns were identified.

**FEDERAL ENERGY REGULATORY COMMISSION  
PHOTOGRAPHIC RECORD**

**Company:** WBI Energy

**Docket Nos.:** CP22-466-000

**Project:** Wahpeton Expansion Project



**Photo No.:** 17

**MP:** 59

**Direction:** North

**Assessment:** Acceptable

**Comments:** Aboveground Facility. Wahpeton Border Station. The Wahpeton Border Station site was cleared and graded. All ECDs were in place, and no environmental concerns were identified.



**Photo No.:** 18

**MP:** 55

**Direction:** South

**Assessment:** Acceptable

**Comments:** Agricultural ROW. The southern half of the ROW was less inundated with water than the northern half, so a welding crew was welding the pipe on this portion of the ROW. No environmental concerns were identified.

**FEDERAL ENERGY REGULATORY COMMISSION  
PHOTOGRAPHIC RECORD**

**Company:** WBI Energy

**Docket Nos.:** CP22-466-000

**Project:** Wahpeton Expansion Project



**Photo No.:** 19

**MP:** 54.5

**Direction:** East

**Assessment:** Acceptable

**Comments:** Agricultural ROW, Bore #67 Site. Welded pipe string was staged along the ROW for the bore crossing, pending favorable working conditions. The ROW was clearly staked, segregated topsoil stockpiles were stable, and no environmental concerns were identified.



**Photo No.:** 20

**MP:** 51.5

**Direction:** West

**Assessment:** Acceptable

**Comments:** Agricultural ROW, Bore #64 Site. Access to the bore site, for crossing beneath the Wild Rice River, was saturated/muddy but protected with equipment mats to allow access for the drill rig. Trenching along the ROW was pending dryer soil conditions. No environmental concerns were identified.

**FEDERAL ENERGY REGULATORY COMMISSION  
PHOTOGRAPHIC RECORD**

**Company:** WBI Energy

**Docket Nos.:** CP22-466-000

**Project:** Wahpeton Expansion Project



**Photo No.:** 21

**MP:** 51.5

**Direction:** West

**Assessment:** Acceptable

**Comments:** Agricultural ROW, Bore # 64 Site. Access to the bore site, for crossing beneath the Wild Rice River, was saturated/muddy but protected with equipment mats to allow access for the drill rig. Trenching along the ROW was pending dryer soil conditions. No environmental concerns were identified.



**Photo No.:** 22

**MP:** 48.9

**Direction:** West

**Assessment:** Acceptable

**Comments:** Aboveground Facility. Valve Set #6. The valve set installation was complete; however, completion of the pad was delayed by heavy rains, rendering the ROW inaccessible. No environmental concerns were identified.

**FEDERAL ENERGY REGULATORY COMMISSION  
PHOTOGRAPHIC RECORD**

**Company:** WBI Energy

**Docket Nos.:** CP22-466-000

**Project:** Wahpeton Expansion Project



**Photo No.:** 23

**MP:** 47.4

**Direction:** Northeast

**Assessment:** Acceptable

**Comments:** Agricultural ROW. The ROW was flooded, preventing access. However, no off-ROW impacts or environmental concerns were identified.



**Photo No.:** 24

**MP:** 44.9

**Direction:** East

**Assessment:** Acceptable

**Comments:** Agricultural ROW, Bore # 57 site. The crossing beneath Pitcairn Creek was in progress. All drilling mud was contained, and no environmental concerns were identified.



**FEDERAL ENERGY REGULATORY COMMISSION  
PHOTOGRAPHIC RECORD**

**Company:** WBI Energy

**Docket Nos.:** CP22-466-000

**Project:** Wahpeton Expansion Project



**Photo No.:** 25

**MP:** 44.8

**Direction:** East

**Assessment:** Acceptable

**Comments:** Agricultural ROW, Bore # 57 Site. The crossing beneath Pitcairn Creek was in progress, and an equipment bridge was properly installed across the waterbody. All drilling mud was contained, and no environmental concerns were identified.



**Photo No.:** 26

**MP:** 42

**Direction:** West

**Assessment:** Acceptable

**Comments:** Agricultural ROW. The ROW west of the onramp to I-29 from County Road 4 was clearly staked, with topsoil properly segregated. No off-ROW impacts or environmental concerns were identified.